



Cartridge Kit for Vane Motor

Catalog 2021

Cartridge Kit for Vane Motor HM Series

Features and Handling

The HM series cartridge kit is interchangeable with Vickers vane motor. It consists of a cam ring, rotor, 10 vanes, and 2 pressure plates. The cartridge is bolted together so parts can be serviced separately or as an assembly. A cartridge can be replaced without removing the unit from the machine, and usually without disconnecting the lines.

To change rotation, reverse the motor ports. No need to do anything with the cartridge.



Specification

Model	Torque Nm/6, 9 bar (lb in/ 100 psi)	Displacement cm ³ /r (in ³ /r)	Flow input / required @1200 r/min L/min (USgpm)	Maximum speeds & Pressure	Approx Weight kg (lb)
25HM & 26HM	3.3 (30)	29.0 (1.77)	34.8 (9.19)	3600 r/min @ 34 bar (500 psi) ¹⁾ 4000 r/min @ 34 bar (500 psi) ²⁾	4.8 (10.5)
	4.7 (42)	43.9 (2.68)	52.6 (13.9)		
	6.2 (55)	57.7 (3.52)	69.3 (18.3)		
	7.3 (65)	68.7 (4.19)	82.5 (21.8)		
35HM & 36HM	9.0 (80)	83.6 (5.10)	100.3 (26.5)		7.4 (16.3)
	10.7 (95)	100.3 (6.12)	120.4 (31.8)		
	13.0 (115)	121.9 (7.44)	146.1 (38.6)		
45HM & 46HM	14.7 (130)	138.0 (8.42)	165.4 (43.7)		2400 r/min @ 155 bar (2250 psi) ¹⁾ 3000 r/min @ 155 bar (2250 psi) ²⁾
	17.5 (155)	163.2 (9.96)	195.7 (51.7)		
	20.9 (185)	193.2 (11.79)	232.0 (61.3)		

- 1) Continuous Operation
2) Intermittent Operation

Cartridge Kit for Vane Motor HM Series

Ordering Code

25 HM - 65
1 2 3

1. Model Series:

25HM, 26HM,
35HM, 36HM,
45HM, 46HM

2. Series

HM - Vane Type Motor (Externally drained)

3. Ring Size - Nominal torque Rating (lb.in./100 psi)

25HM/26HM - 30, 42, 55, 65
35HM/36HM - 80, 95, 115
45HM/46HM - 130, 155, 185

Installation Dimension mm (inch)

Cartridge Kit 25HM & 26HM

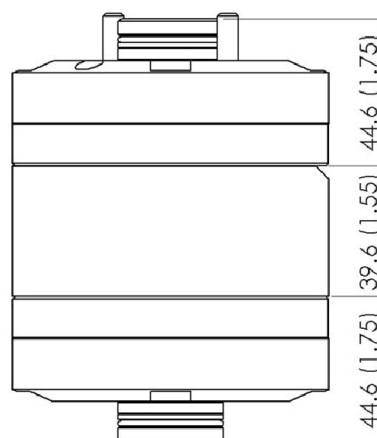

Cartridge Kit for Vane Motor HM Series

Cartridge Kit 35HM & 36HM

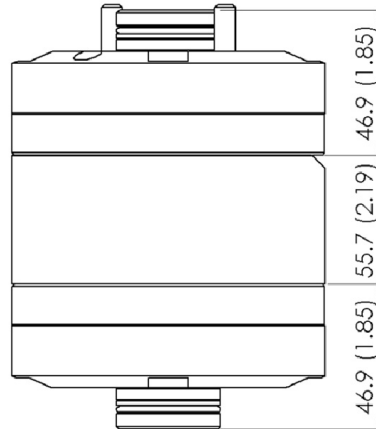

Cartridge Kit 45HM & 46HM

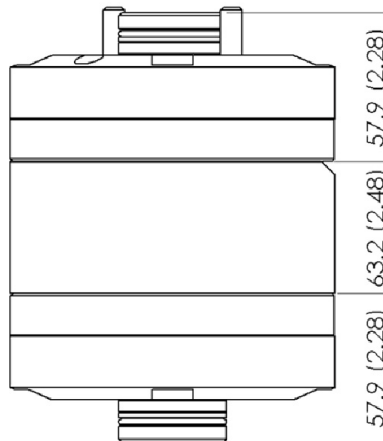

HOF Hydraulic represented by

Flowlution Co.,Ltd.

26/48 Moo4 Suksavadh Road, Jomthong, 10150 Bangkok, Thailand
Tel: +662 877 3223 Fax: +662 877 3373 info@flowlution.com

HOF Corindus Co.,Ltd. (Thailand only)

891 Rama3 Road, Bangpongpan, Yannawa, 10120 Bangkok
Tel: 02 284 1100 Fax: 02 683 4414 info@hofcorindus.co.th
www.hofcorindus.co.th